

HSC Pool Locations and Directions

Practice Calendar Code: HCHS
Don Watson Aquatic Center at Hinsdale Central High School
5500 S. Grant Street, Hinsdale

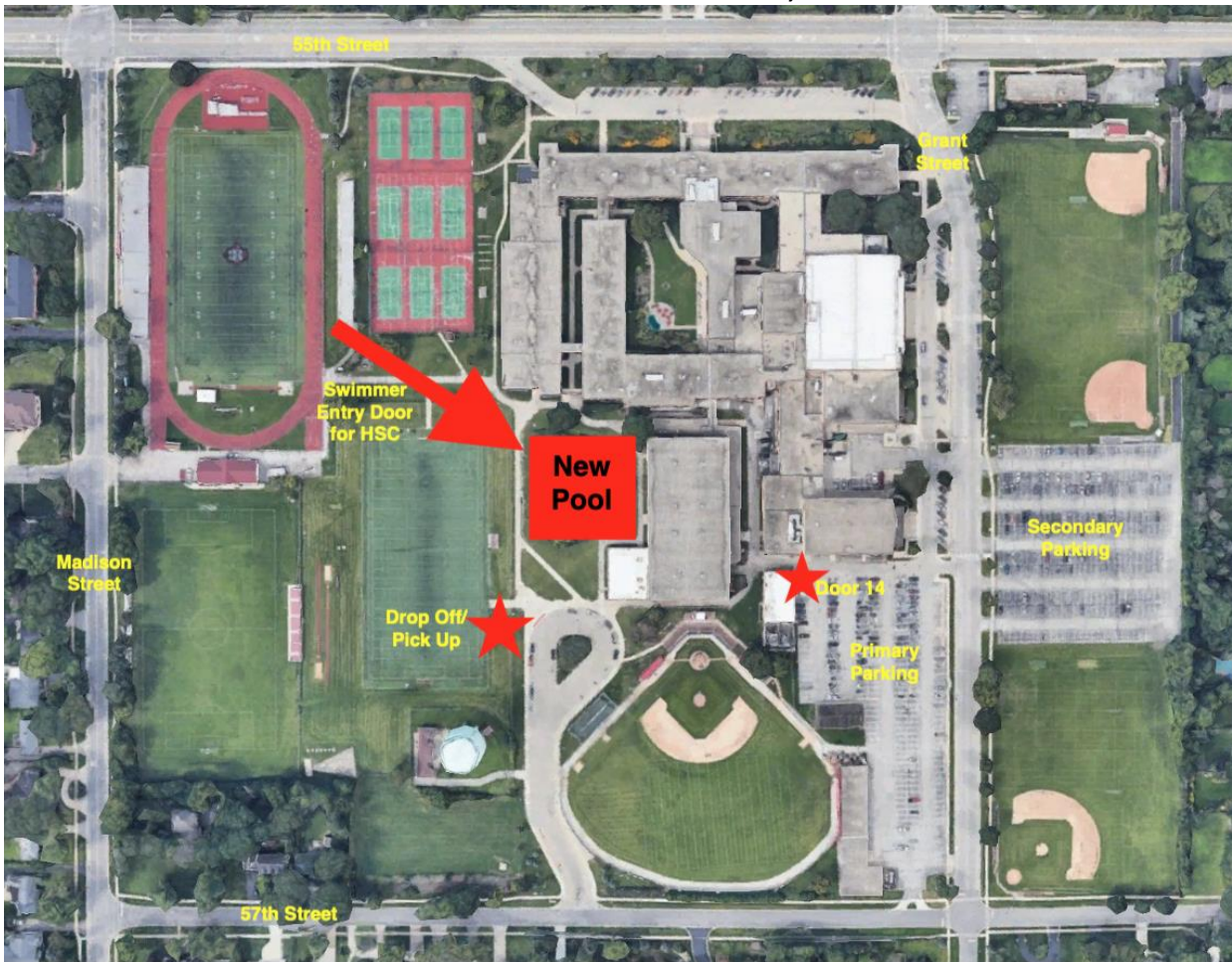

Swimmers can be dropped off at the indicated drop off/pick up point or they can walk through the school building using Door 14.

After practice all swimmers must exit through the door labeled "Swimmer Entry Door for HSC". Swimmers will NOT be permitted to walk through the building to exit at Door #14.

Practice Calendar Code: 5S
Indoor Pool=5S(I), Outdoor Pool=5S(O)
Five Seasons Family Sports Club
6901 S. Madison Street, Burr Ridge

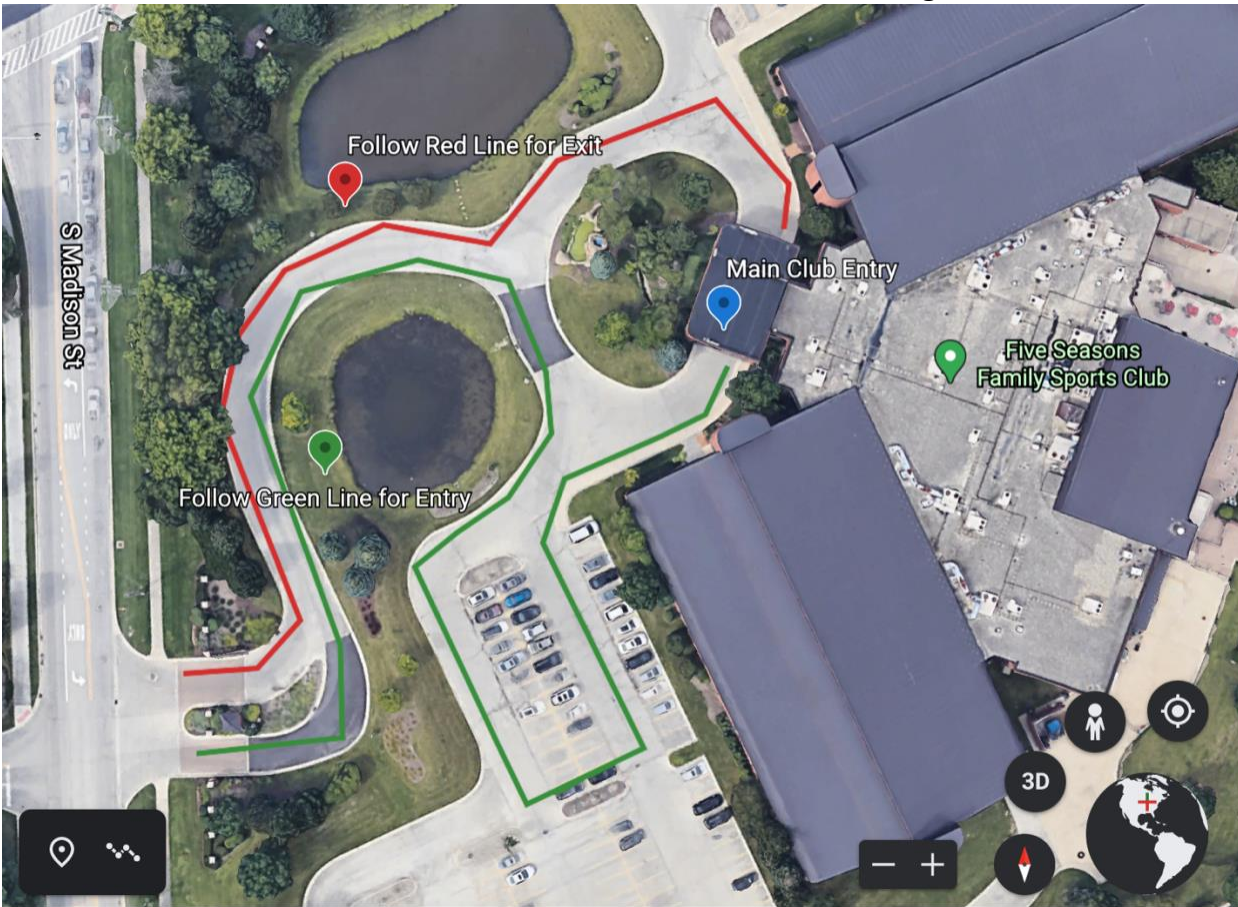

Please follow the designated paths for swimmer drop off and pickup. Swimmers use the same entrance for both the indoor and outdoor pools.

Practice Calendar Code: Lodge
The Hyatt Lodge
2815 Jorie Blvd, Oak Brook



Turn off Jorie Blvd and pass a security gate. Turn left onto Ronald Lane at the next intersection. The Hyatt Lodge building will be on your left. Drive past it, over a small bridge for parking/turnaround on the right (highlighted in green). The area highlighted in red is where the drop-off/pickup takes place.

It is easiest to turn around in the parking lot, cross back over the bridge and let your child get out safely by the sidewalk (so that they do not have to cross a street). Please arrive 5 - 10 minutes before the practice start time. A coach will lead swimmers to the pool at the designated start time. If late, please park and walk your swimmer in using the same door and route that the team uses. The same applies if your swimmer needs to leave early: please come to the pool to get your child. No swimmer can walk to or from the pool without parent/coach.

The practice end time noted is when swimmers finish practicing in the water. By the time swimmers get dressed and walked through the hotel, it will be 5-10 minutes before you see them (at the same door they entered.)

- You CANNOT park on the bridge or block the loading dock near the bridge
- You CANNOT leave your car unattended on the bridge
- Drop off and pick up from near the bridge area should be just past the bridge, as not to create a fire hazard
- If you plan to leave your car, you must park in the parking lot

Practice Calendar Code: BPD
Bensenville Park District, Water's Edge Aquatic Center
545 John Street, Bensenville



Swimmer drop-off and pickup takes place at the door of the pool building. Please do not park along the sidewalk next to the building, this is a fire lane. If you need to come into the building please park in the parking lot.